

# THE NEW PT-300



**PRIME  
TECH**®

a brand of FAE Group



# World wide support and customer service

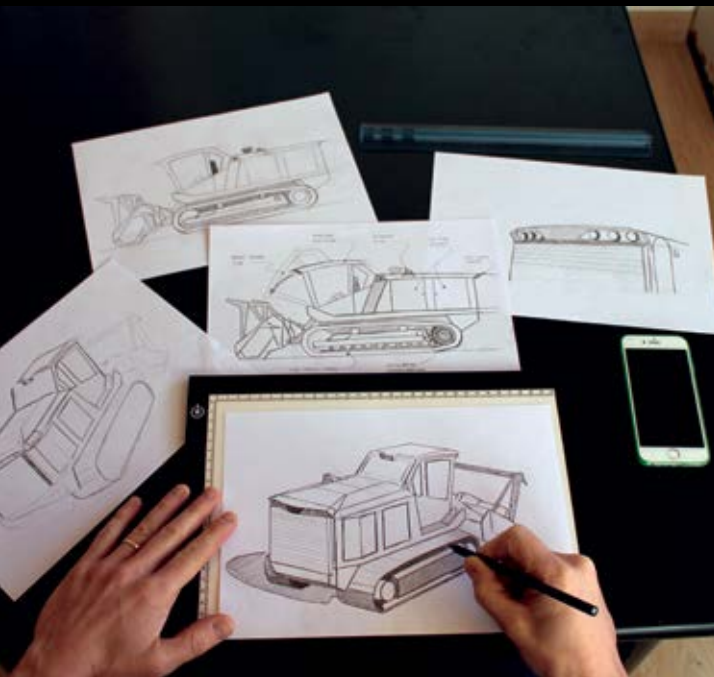

PrimeTech is a brand of FAE Group, an Italian company that has been leading the land clearing industry since 1989. We design and manufacture heavy-duty mulchers and tracked carriers (prime movers). These machines are perfect for forestry, agriculture and construction applications all over the world. Entirely designed and manufactured by PrimeTech in Italy, the PT Series features

components exclusively provided by leading parts manufacturers like Caterpillar, Danfoss, Berco, Parker, FAE, and so on. Combined with our strict design standards, these top-notch parts guarantee outstanding performance and reliability, securing PrimeTech's leading position in the market. Our tracked carriers can tackle a variety of land clearing applications: vegetation management, ROW clearing,

land conversion and reclamation, soil stabilization, site preparation, road construction and maintenance, etc. FAE Group's six international offices (in the U.S., Canada, Russia, Australia, Germany, and France), combined with an extensive dealer network, provide an outstanding choice of machinery solutions and dedicated customer service for customers all over the globe.





# A high performance brand



PrimeTech carriers are well known for their unparalleled reliability, efficiency, and performance. The unstoppable PT-300 features the following:

> The fuel-efficient CAT C7.1 Acert 71 (428 in3) turbocharged and after cooled engine with six in-line cylinders that can be offered both in Tier 3/Stage IIIA (producing 275 hp) and in Tier 4 Final/Stage IV (emissions standards) that produces 302 hp. In both versions, the power output is achieved at a lower rpm (2,200), meaning better performance with lower fuel consumption. With regards to the Tier 4 Final, the engine achieves its compliance through an innovative combination of the particulate filter (DPF), selective catalytic reduction (SCR), and diesel oxidation catalyst (DOC) technologies, which help maximize uptime and performance — all with minimal maintenance.

The powerful and efficient hydraulic system, equipped with variable torque motors, provides a series of advantages over mechanical transmission:

- Continuous operation in an engine rpm range of 1,700-2,200, which is the most efficient rpm range for this type of applications.
- Hydraulics act as a shock absorber: fewer vibrations are transmitted to the machine and its main parts; this results in less wear and tear and substantially reduce operating and maintenance costs.
- A larger lifting range for the front attachment, meaning greater flexibility.
- Brief recovery time.



# Extremely low ground pressure



One of the main advantages of PT-300 is the extremely low ground pressure. The oscillating undercarriage ensures a large contact surface, resulting in excellent stability, smooth driving and extraordinarily low ground pressure.

The D4 HD undercarriage is engineered to work on very steep slopes and in muddy and soft terrain (muskeg and marshland). Sealed and lubricated track chains and dozer-style rollers guarantee an extended lifetime, thus reducing maintenance and operating costs.



# Unmatched versatility

A wide range of front attachments is available for PT-300, making it a very versatile tracked carrier. All the attachments can be switched in no time, allowing you to use PT-300 for different applications.

> Use the **Forestry mulcher FAE 200/U or 300/U** for the following applications:

- Land clearing for the oil and gas industry: seismic lines, pipelines, leases, etc.
- Site preparation and clearing for the construction sector: roads, subdivisions, etc.
- Vegetation management: fence lines, powerlines, windmills, ROW clearing etc.
- Plantations: palm tree, pineapple, sugar cane, eucalyptus and pine plantations
- To cut fire-breaks for fire suppression
- Disaster management: firebreaks, disaster clean-up, etc.

Both redesigns offer new advanced features, including the following:

- New push-frame structure to reach the ground for dragging and raking
- Bolt-on counter blades for quicker change and reduced maintenance cost
- Adjustable skids to set required working depth
- Reinforced frame and hood.

> Use the **Forestry tiller / subsoiler head FAE 200/S** for the following applications:

- Land conversion: clear stumps and roots to convert forests / pasture / woodland into farmland
- Clear stumps and root systems before replanting in plantations, etc.
- Clear stumps and roots in road construction (after harvesting or mulching the trees)
- Strip the frozen top soil for excavation.

> Use the **Soil stabilizer / asphalt grinder and rock crusher FAE RSL/HY** for the following applications:

- To stabilize soil in road construction: mix the soil with additives like lime, cement, etc.
- To reclaim land for road preparation
- To mill and profile asphalt of an existing pavement
- To crush rocks in road construction
- To build and maintain gravel and forestry roads
- To crush rocks on ski slopes to make snowmaking easier
- To grind rock on farmland and pastures.

> **The Stump cutter FAE 300/SC**, the ideal choice for land clearing operations as well as right-of-way maintenance.

This powerful shredding attachment features two Bosch Rexroth® hydraulic motors and an aggressive cutting wheel consisting of 40 carbide teeth to power its way through the toughest stumps.



# F&E: new improved rotor design with new generation teeth

## Double spiral rotor design

The double spiral layout guarantees an even distribution of mulched material leaving no windrow of finished product in the middle.

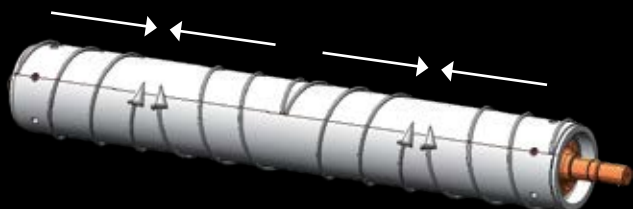

## New tooth holder design

Larger welding surface of tooth holder to drum improving the mounting of the tooth and holder.

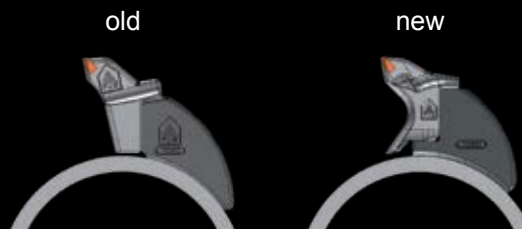

## New tooth and bolt design

New, more resistant tooth and bolt design.

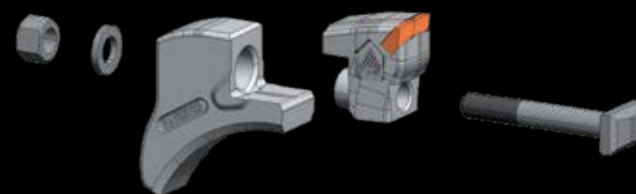

## A wide range of teeth are available

200/U and 300/U (interchangeable teeth)



Tooth type C/3



Tooth type C/3-HD



Tooth type STCL/3



Tooth type K

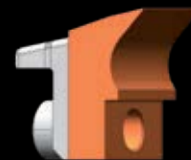

Tooth type C/3 blade



Tooth type I



Tooth type B/3\*



Tooth type B/3/HD\*

\* for 300/U only

200/S (interchangeable teeth)



Tooth type  
B/3



Tooth type  
B/3/HD

300/SC



Tooth  
type M1



Tooth  
type M2



Tooth  
type M3



Tooth  
type M4

RSL/HY (interchangeable teeth)



Tooth type  
R 65\*\*



Tooth type  
R/HD 65\*\*



Tooth type R 44-22  
with adaptor\*\*



Tooth type  
G/3\*\*\*



Tooth type G/3/R  
44 with adaptor\*\*\*

\*\*interchangeable teeth with type R rotor

\*\*\*interchangeable teeth with type G rotor

# A reliable, easy-to-operate and service machine

Our PT carriers are known for their high reliability and minimal downtime. Our unique design maximizes productivity and efficiency, while minimizing the operational cost.

To simplify the cleaning and maintenance, all parts of PT tracked carriers are easily accessible.

The machine package includes an air compressor and air tank to assist you with debris removal and minimize cleaning time.

The NEW improved cabin:

- Enjoy a spacious interior with excellent visibility
- Unmatched soundproofing: 78 dB with the front attachment working!
- The minimal level of vibrations
- The ergonomic position of joysticks
- 7" color display to simplify machine operation and settings customization
- Diagnostics and troubleshooting via display includes

data storage on a USB drive

- The air conditioning system
- Comfort and air suspended driver's seat
- MP3/CD player®
- Lexan Margard® cabin windshields, made with highly shock-proof and scratch resistant material
- Double emergency exit on top and at the side of the cabin
- ROPS/FOPS/OPS - approved
- LED lights







PT-300 features an oversized radiator with high cooling capacity for hydraulic oil, air, and water, even when working in scorching conditions. The radiator comes with coarse fins, preventing them from getting plugged by dust and dirt and making cleaning much easier, maximizing engine performance and saving fuel.

You can customize your radiator with a proportional and reversible fan. The pitch sensor fan (a closed-loop system) in combination with the ECU of the machine monitors the temperatures. This feature allows automatic airflow adjustment by changing the pitch of the fan blades. The fan provides the most optimized airflow for efficient cooling for your exact conditions. This highly responsive cooling system will allow you to conserve fuel.

Additionally, the fan design and position help keep your engine clean.

The cooling system is hydraulically-driven, ensuring maximum reliability (compared to belt-driven fans with blades adjusted by a separate air compressor).



# PT-300: Technical specifications

## > DIMENSIONS

<b>A</b> Overall length without mulcher	195 in	4950 mm
<b>D</b> Ground clearance	18 in	467 mm
<b>E</b> Hitch angle	34°	
<b>F</b> Overall length with mulcher on ground	240 in	6088 mm
<b>G</b> Transport length with mulcher on ground	257 in	6526 mm
<b>G1</b> Transport length with mulcher on ground and winch	272 in	6900 mm
<b>L</b> Max height	110 in	2785 mm

VERSION	STD		LGP	
Track width	26 in	660 mm	32 in	800 mm
<b>H</b> Track gauge	67 in	1700 mm	67 in	1700 mm
<b>I</b> Overall track width	93 in	2360 mm	98 in	2500 mm

FAE ATTACHMENT	200/U-200		200/U-225	
<b>K</b> Overall width	97 in	2475 mm	107 in	2715 mm
<b>K1</b> Working width	81 in	2060 mm	91 in	2300 mm

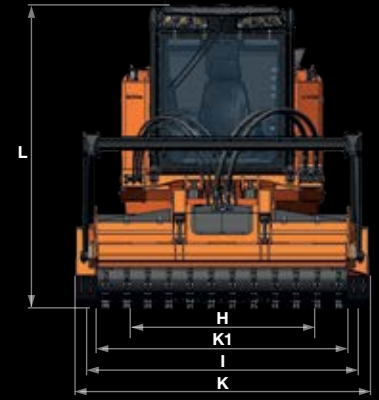
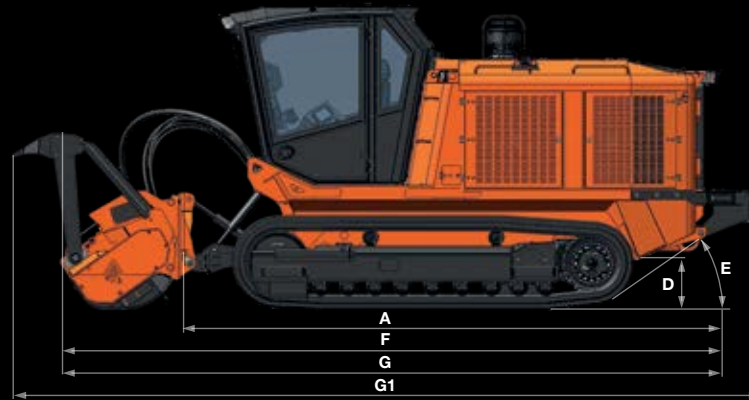

## > MAIN KEYS

• Max forward speed	4 mph	6.5 km/h
• Max reverse speed	4 mph	6.5 km/h
• Drawbar pull	40690 lbf	18100 daN
• Gradeability	100%	
• Tracks control	Danfoss Electric Joystick	
• Service hydraulic circuit control	Danfoss Electric Joystick	

• Parking brake	Negative, hydraulically activated
-----------------	-----------------------------------

VERSION	STD		LGP	
• Track width	26 in	660 mm	32 in	800 mm
• Operating weight	30732 lbs	13940 kg	31769 lbs	14410 kg
• Ground pressure	4.40 psi	0,31 kg/cm <sup>2</sup>	3.69 psi	0,26 kg/cm <sup>2</sup>

## > DIESEL ENGINE

VERSION	Tier 4F		Tier 3	
• Model	CAT C7.1 Acert		CAT C7.1 Acert	
• Gross Power	302 HP	225 kW	275 HP	205 kW
• Rating	2200 rpm		2200 rpm	
• Displacement	428 in <sup>3</sup>	7 l	428 in <sup>3</sup>	7 l

VERSION	Tier 4F		Tier 3	
• N° of cylinders	6		6	
• Torque max	940 lb-ft	1274 Nm @1400 rpm	774 lb-ft	1050 Nm @1400 rpm
• Fuel rate from	7 gal/h	28 l/h	7 gal/h	l/h
• Emission	U.S. EPA Tier 4 Final / EU Stage V		U.S. EPA Tier 3 / EU Stage IIIA	

## > HYDROSTATIC TRACKS TRANSMISSION

• Pumps (2)	Danfoss	78 cc
• Motors (2)	Danfoss	80 cc
• Max pressure	6000 psi	420 bar
• Oil flow	104 gal/min	395 l/min
• Hydraulic Emergency stop		

## > HYDROSTATIC MULCHER TRANSMISSION

VERSION	Tier 4F		Tier 3A	
• Pump (1)	Danfoss	147 cc	Danfoss	130 cc
• Motors (2)	Danfoss	110 cc	Danfoss	110 cc
• Work pressure	5100 psi	350 bar	5100 psi	350 bar
• Oil flow	98 gal/min	371 l/min	87,5 gal/min	330 l/min

## > REFILLING

• Hydraulic oil tank	85 gal	320 l
• Fuel tank	103 gal	390 l

## > UNDERCARRIAGE AND TRACKS

• Undercarriage	D4, oscillating	
• Track shoes single grouser type:	26 in	660 mm
double grouser type:	32 in	800 mm



# FAE front attachments

## > FAE ATTACHMENT 200/U

MODEL	200/U-200		200/U-210		200/U-225		MODEL	200/U-200	200/U-210	200/U-225
• Rotor diameter	20 in	500 mm	20 in	500 mm	20 in	500 mm	• Quantity of cutting teeth	42+2	44+2	46+2
• Overall width	97 in	2464 mm	100 in	2548 mm	106 in	2704 mm	• tungsten carbide type "C/3"			
• Working width	81 in	2060 mm	85 in	2150 mm	91 in	2300 mm	• Rotor rpm	2325		
• Weight with options	6063 lbs	2750 kg	6217 lbs	2820 kg	6526 lbs	2960 kg	• Hydraulic motor type (2)	Danfoss 110 cc		
• Max. working depth	3 in	80 mm	3 in	80 mm	3 in	80 mm				
• Grinding diameter (max)	14 in	350 mm	14 in	350 mm	14 in	350 mm				

## > FAE ATTACHMENT 300/U

MODEL	300/U-200		MODEL	300/U-200
• Rotor diameter	23 in	600 mm	• Quantity of cutting teeth	72+2
• Overall width	98 in	2494 mm	• tungsten carbide type "B/3"	
• Working width	81 in	2064 mm	• Quantity of cutting teeth	
• Weight with options	7496 lbs	3400 kg	• tungsten carbide type "C/3"	44+2
• Max. working depth	4 in	100 mm	• Rotor rpm	1690
• Grinding diameter (max)	16 in	400 mm	• Hydraulic motor type (2)	Danfoss 110 cc

## > FAE ATTACHMENT 300/SC

MODEL	300/SC		MODEL	300/SC
• Cutter wheel diameter	40 in	1020 in	• Cutting height	39 in 990 mm
• Overall width	29 in	736 in	• Swing angle	70° total
• Working width	79 in	2000 in		(35° left, 35° right)
• Cutter wheel width	6 in	156 in	• Q.ty of carbide teeth	36
• Weight	5027 lbs	2280 lbs	• Rotor rpm	980
• Max working depth	41 in	1050 in	• Hydraulic motor type	Danfoss 250 cc

## > FAE ATTACHMENT 200/S

MODEL	200/S-200		200/S-225		MODEL	200/S-200	200/S-225
• Rotor diameter	24 in	600 mm	24 in	600 mm	• Quantity of cutting teeth	74+4	82+4
• Overall width	95 in	2420 mm	105 in	2660 mm	• tungsten carbide type "B/3"		
• Working width	82 in	2080 mm	91 in	2320 mm	• Rotor rpm	500	
• Weight with options	6504 lbs	2950 kg	6912 lbs	3135 kg	• Hydraulic motor type (2)	Bosch Rexroth 180 cc	
• Max. working depth	12 in	300 mm	12 in	300 mm			
• Grinding diameter (max)	12 in	300 mm	12 in	300 mm			

## > FAE ATTACHMENT RSL/HY

MODEL	RSL/HY-200		RSL/HY-225		MODEL	RSL/HY-200	RSL/HY-225
• Rotor diameter	24 in	600 mm	24 in	600 mm	• Quantity of cutting teeth		
• Overall width	93 in	2360 mm	101 in	2560 mm	• tungsten carbide type "R"	138+16	154+16
• Working width	77 in	1960 mm	87 in	2200 mm	• Quantity of cutting teeth		
• Weight with options	7408 lbs	3360 kg	7848 lbs	3560 kg	• tungsten carbide type "G/3"	62+6	72+6
• Max. working depth	11 in	270 mm	11 in	270 mm	• Rotor rpm	400	
• Grinding diameter (max)	6 in	150 mm	6 in	150 mm	• Hydraulic motor type (2)	Danfoss 250 cc	



# Custom-made options: the flexibility you were looking for

04/19



Screen for front windshield



Rear winch with 6 t pulling power



Oil fill pump



Rock guards



Rear view camera with separate LCD display



Pre-heating system



Canopy



Air-shut-off system



Additional light package



Fire suppression system



Second stage air filtration with ejector



Rear bumper



Reversible fan



Air cleaning system for front windshield



Drain filter for travel and mulcher circuit



Floating D-attach for H-frame



Track chain guides



Pressurizer

Specifications and design are subject to change without notice. Pictures may contain optional accessories. The information in this catalogue is considered non-binding.